

# STANDARD CODE COMPLIANT SPIRAL STAIR

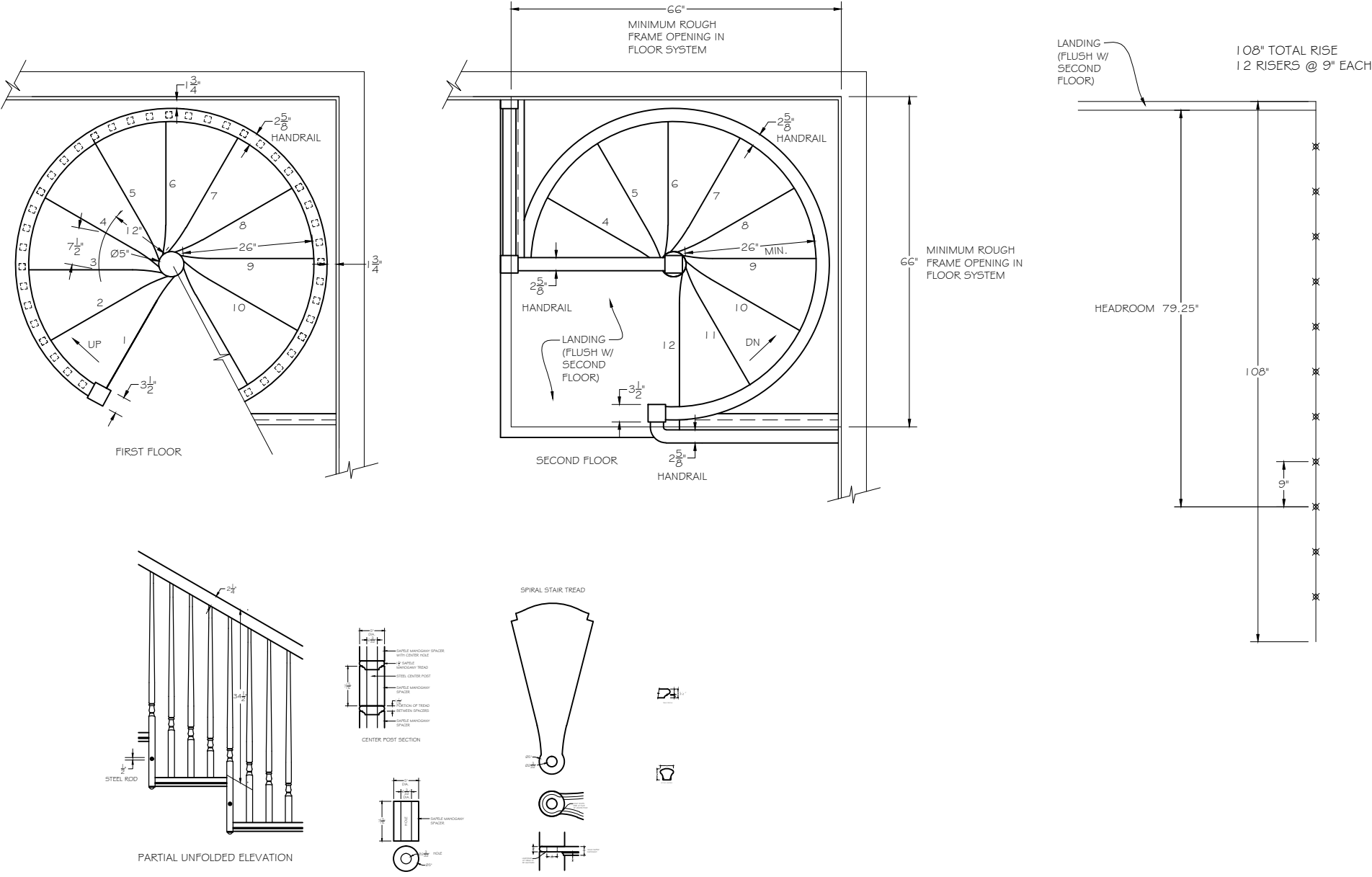

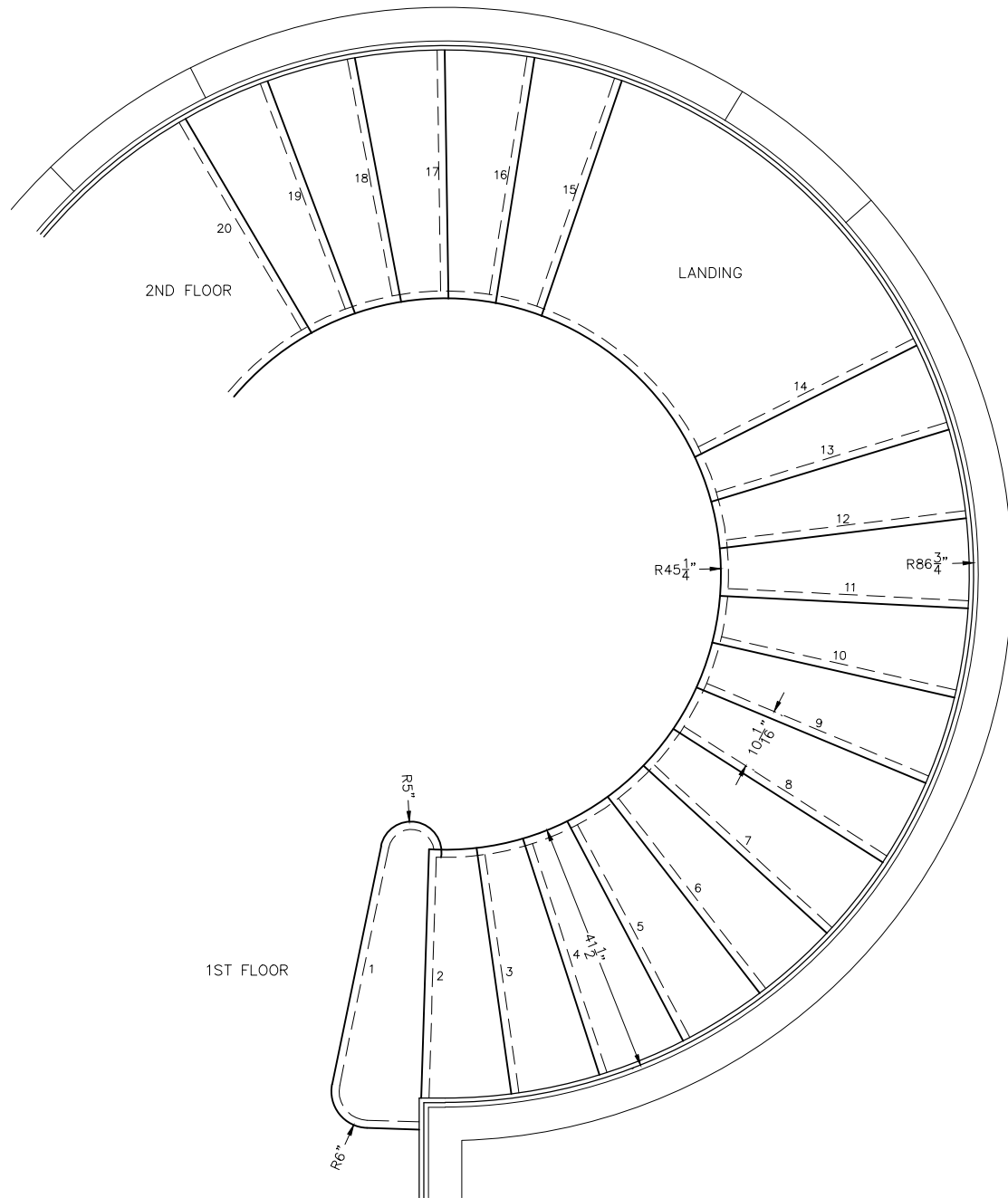

PLAN

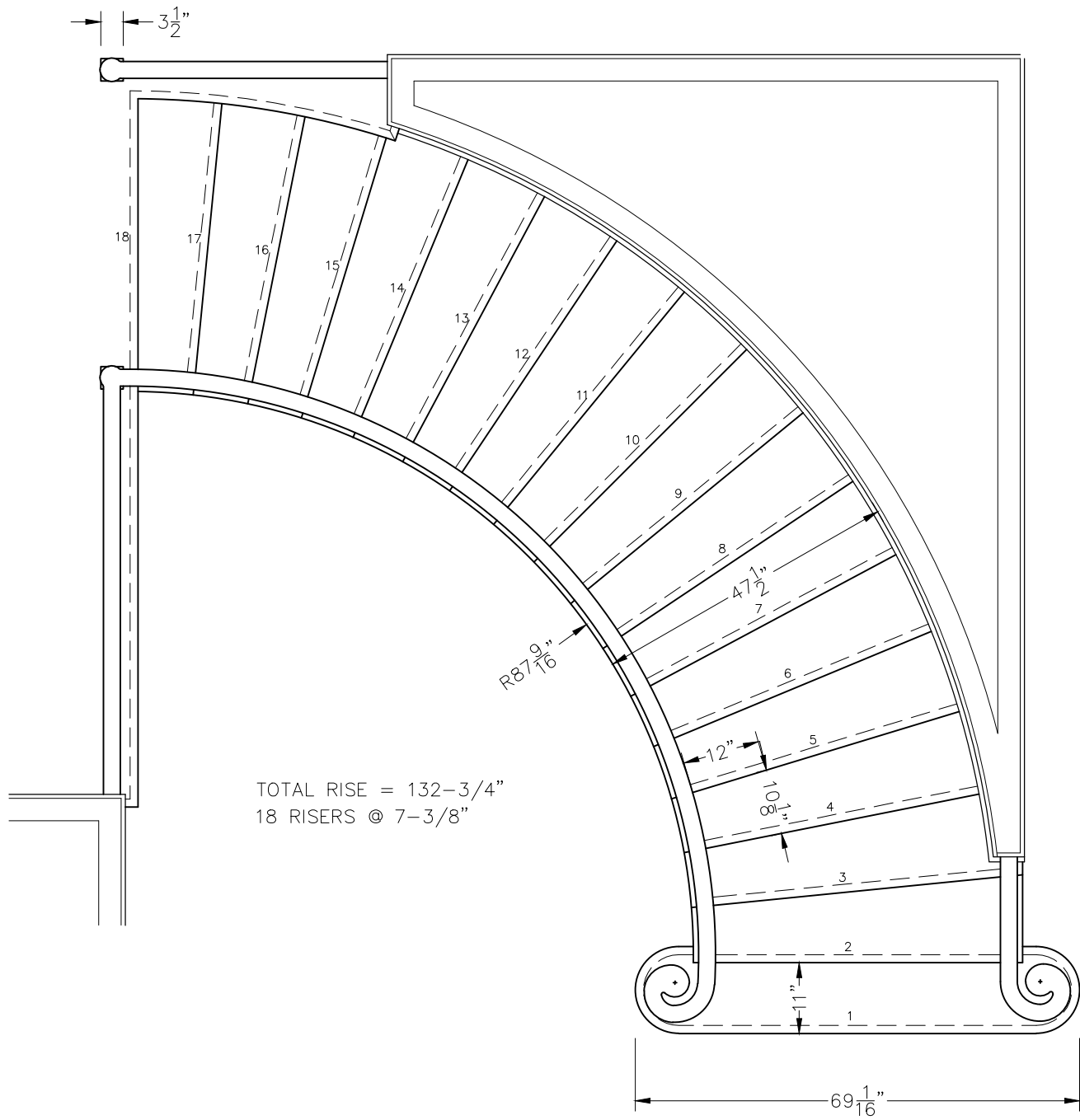

PLAN



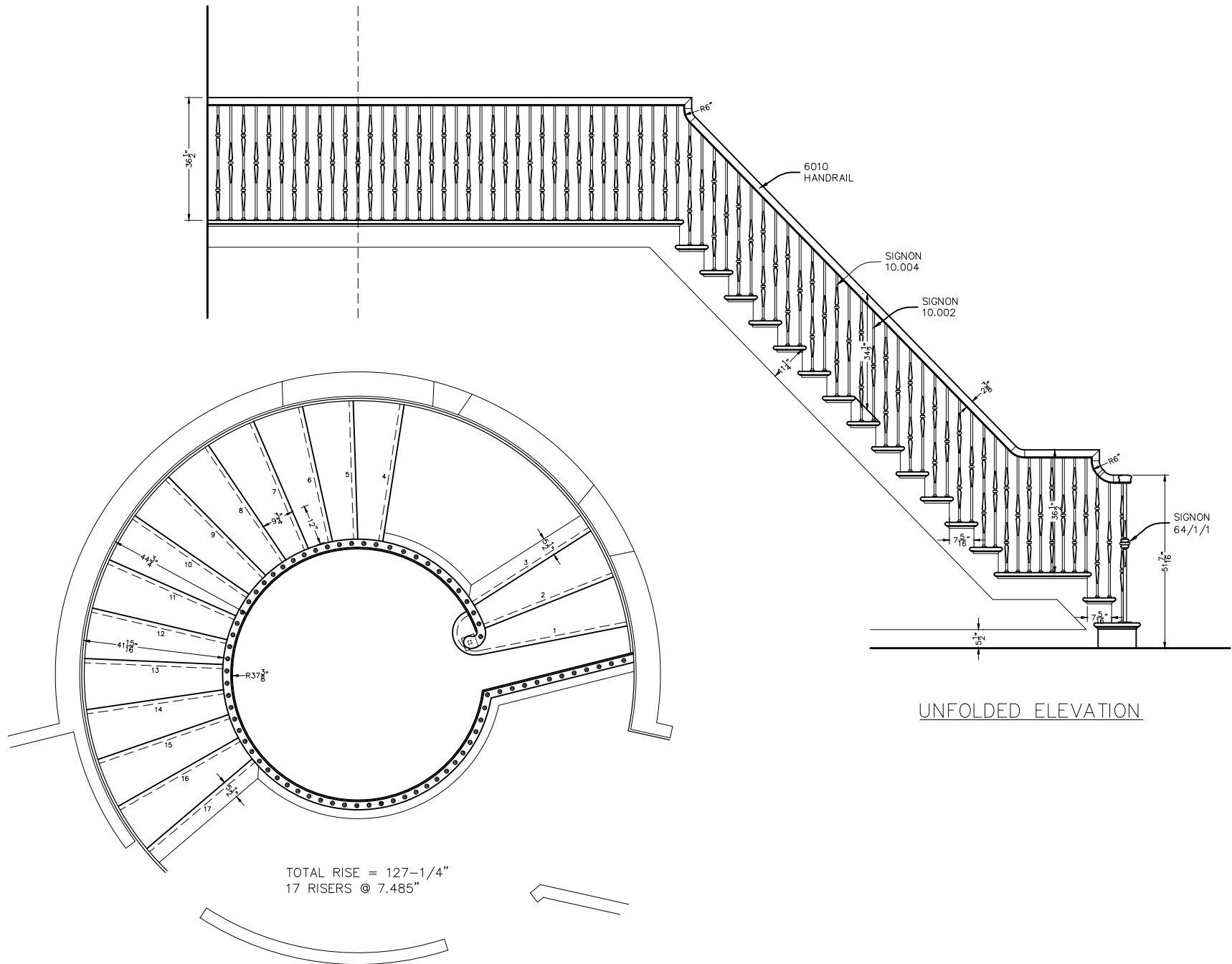

UNFOLDED ELEVATION

TOTAL RISE =  $127-1/4"$   
 17 RISERS @  $7.485"$

PLAN

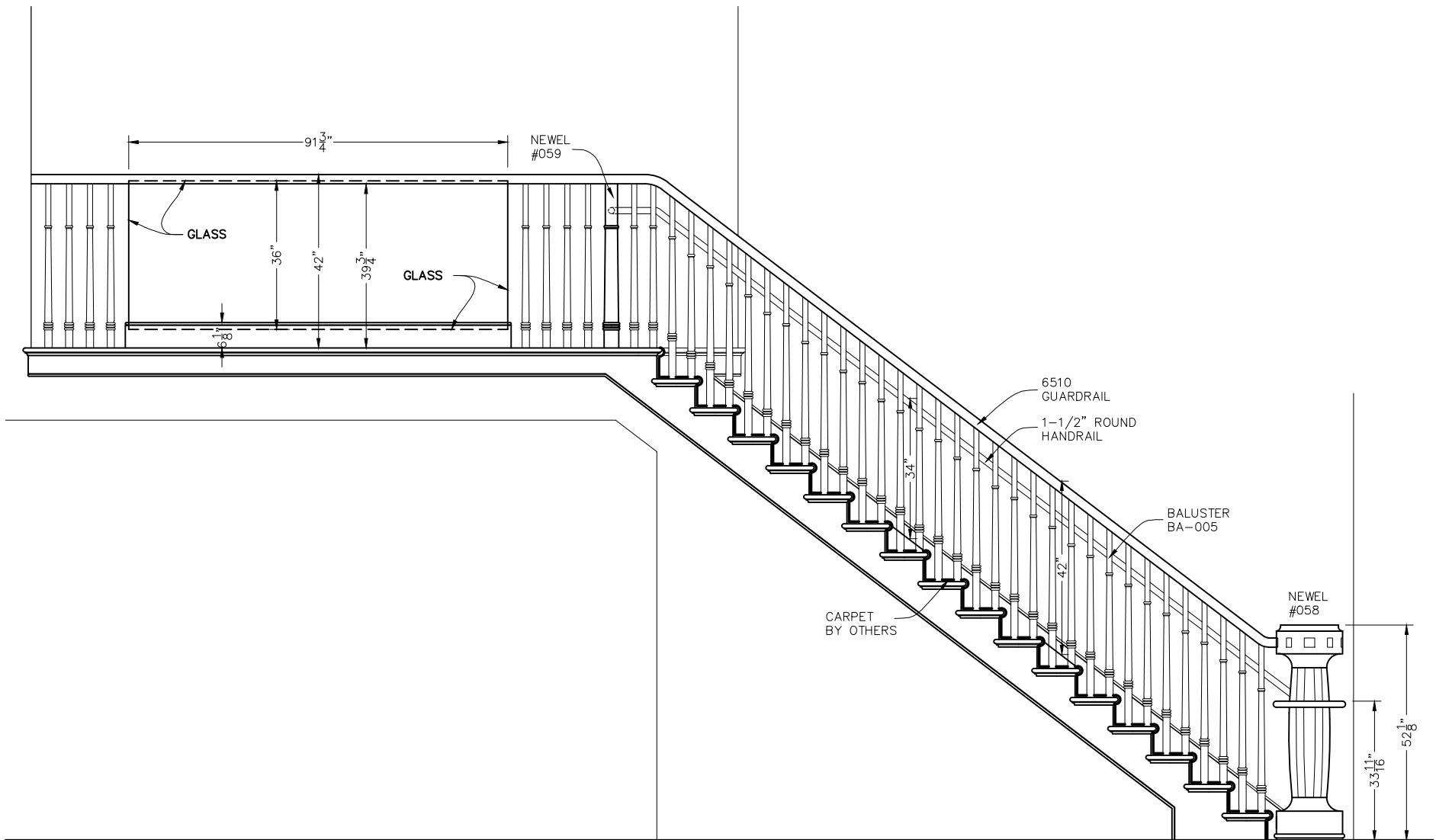

UNFOLDED ELEVATION

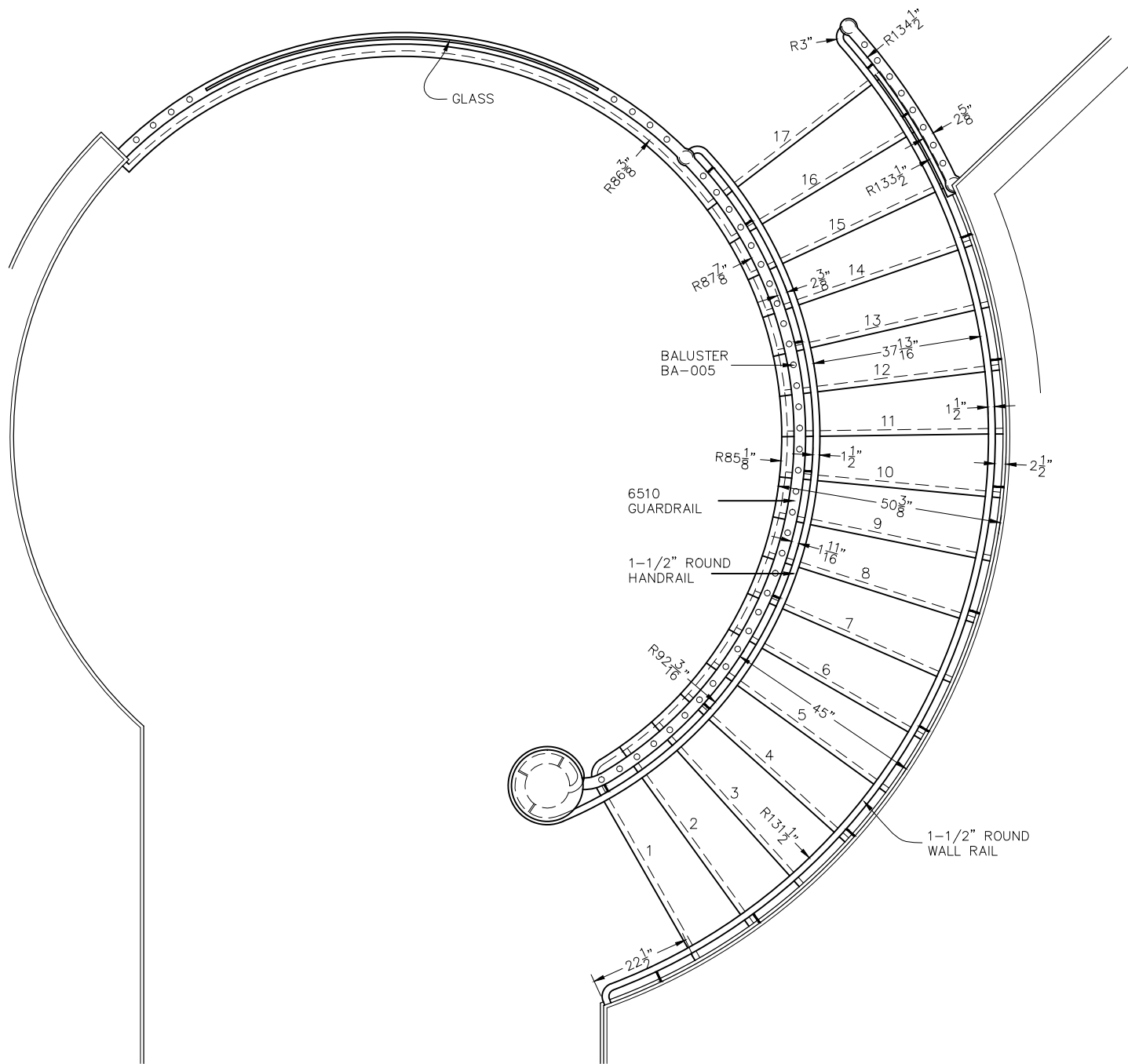

PLAN

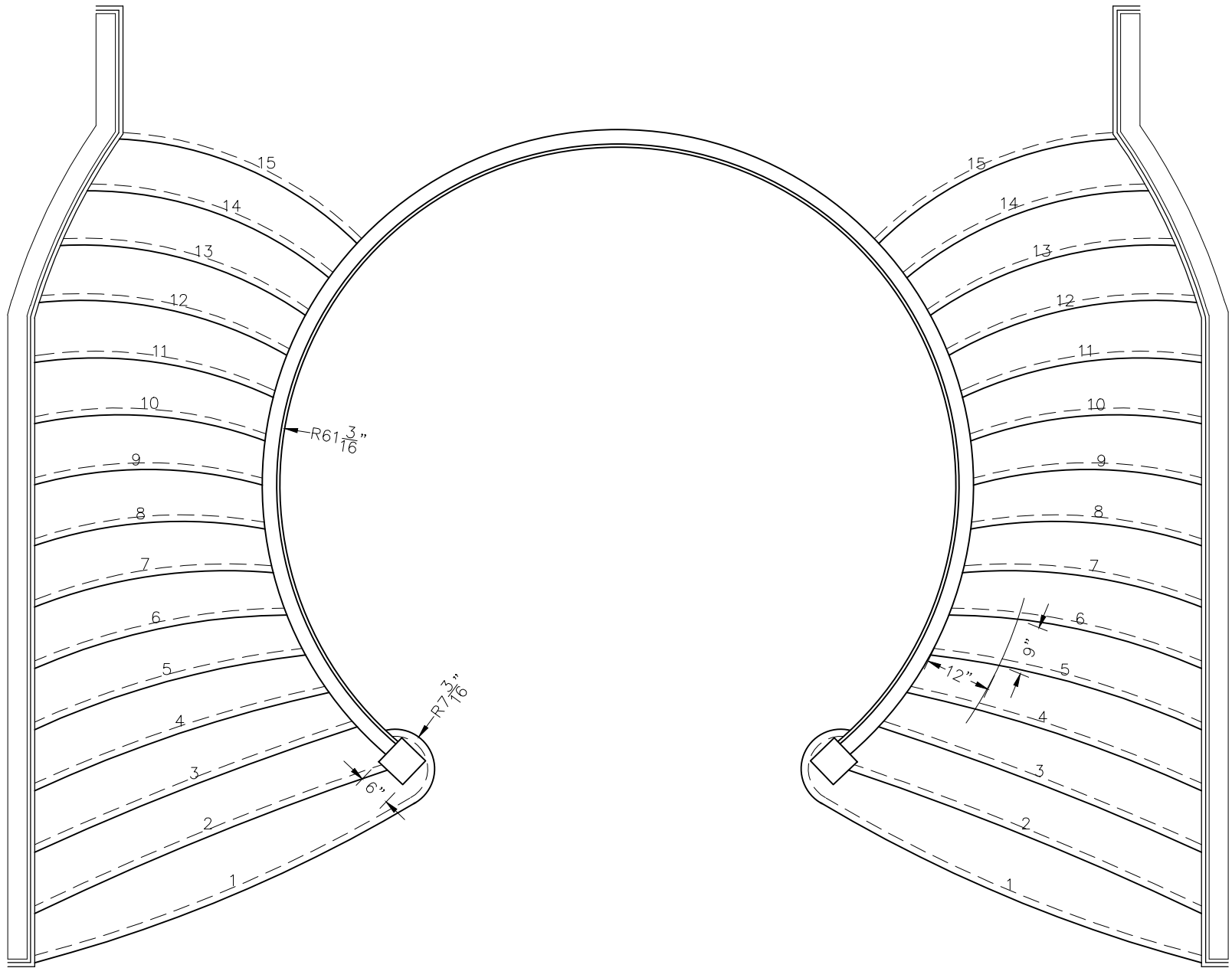

PLAN



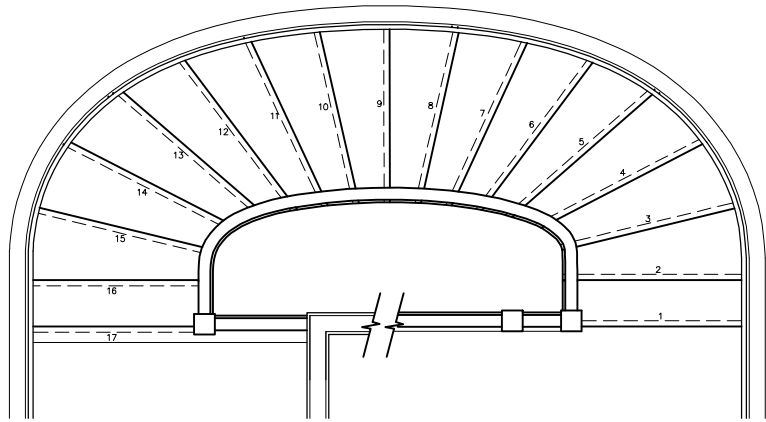

PLAN #1

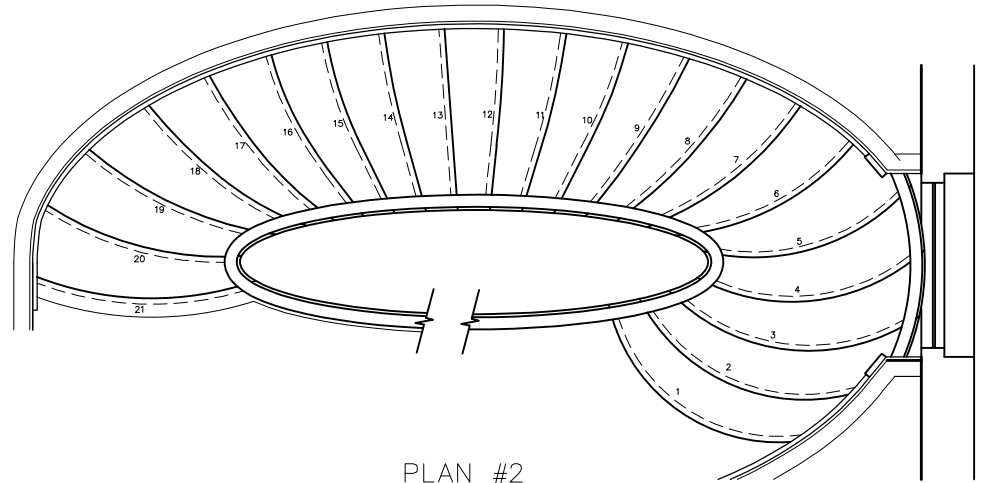

PLAN #2

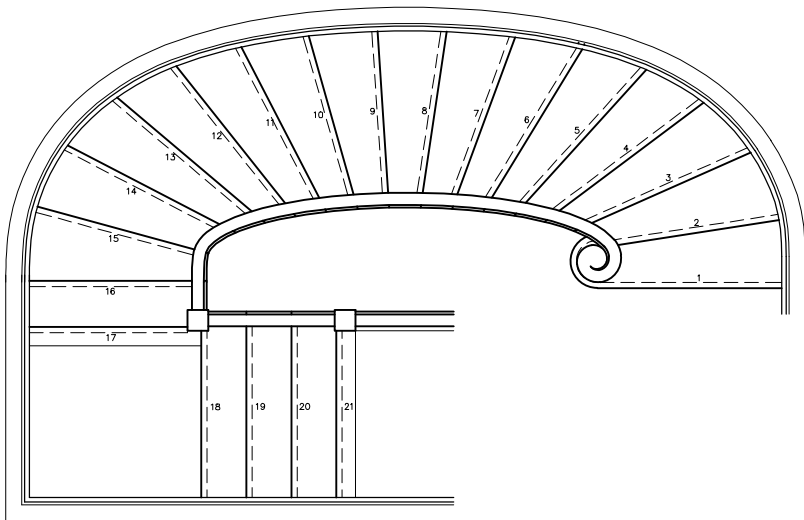

PLAN #3

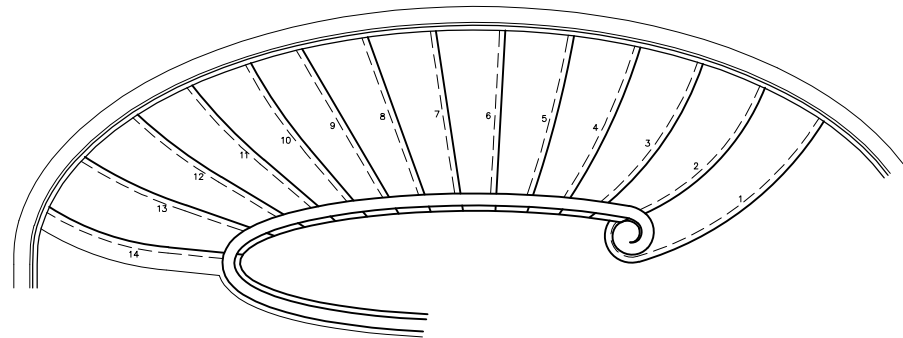

PLAN #4

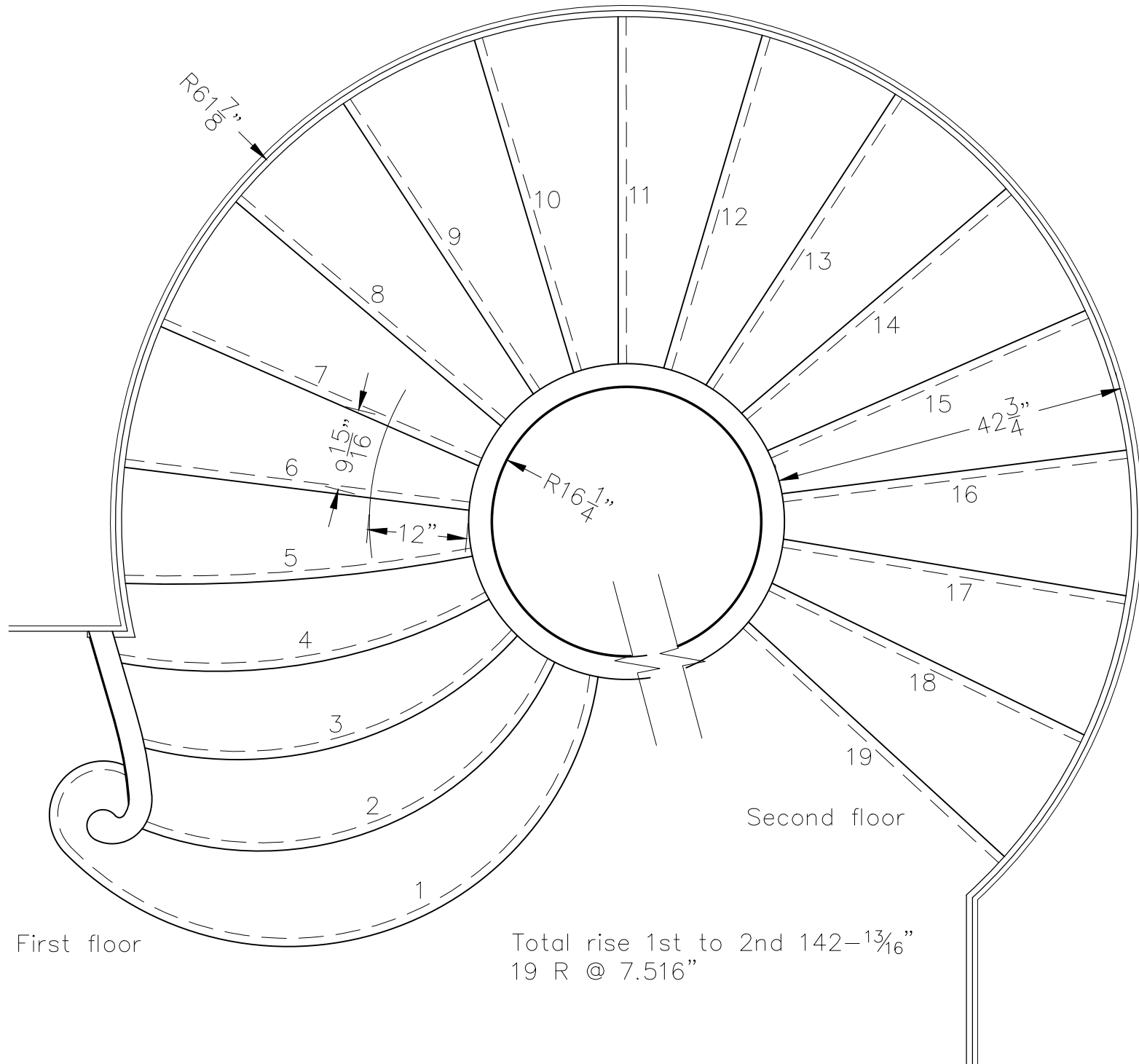

First floor

Second floor

Total rise 1st to 2nd  $142\text{--}13\frac{1}{16}"$   
 19 R @  $7.516"$

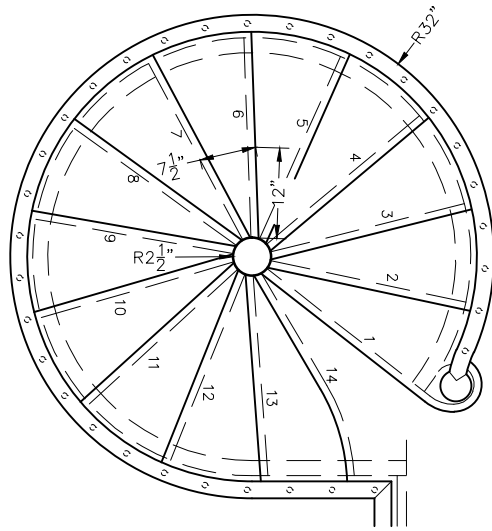

PLAN

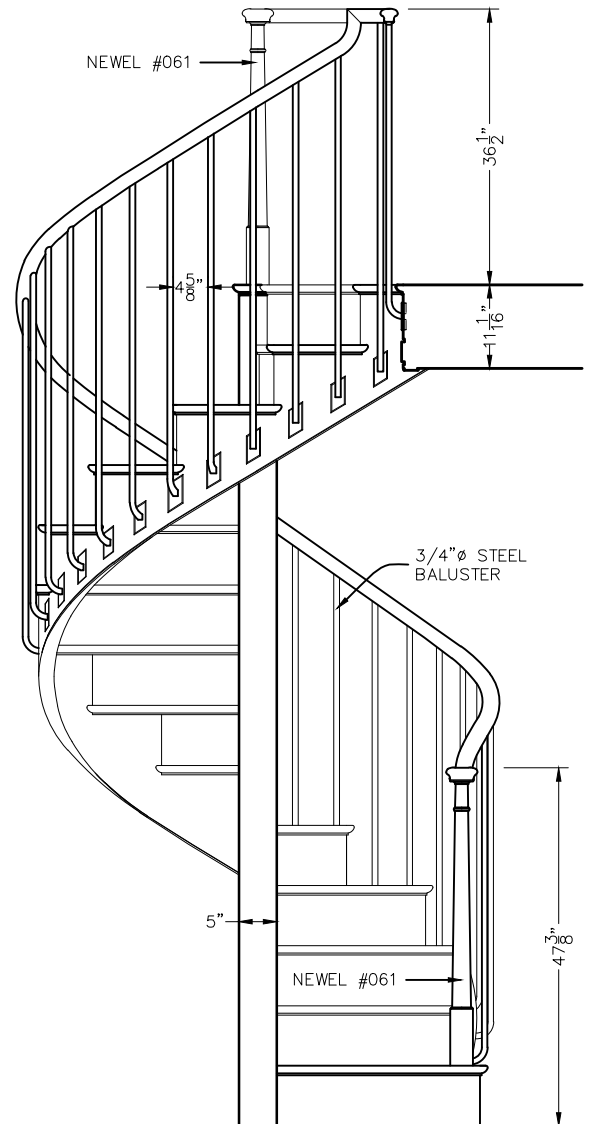

ELEVATION

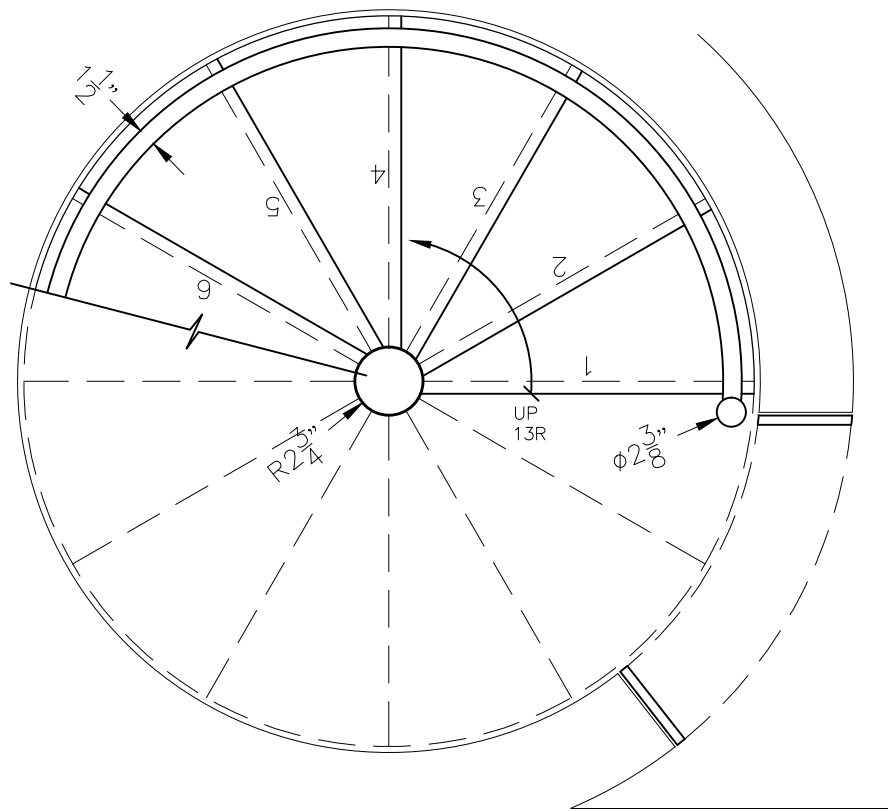

FACE OF PLASTER

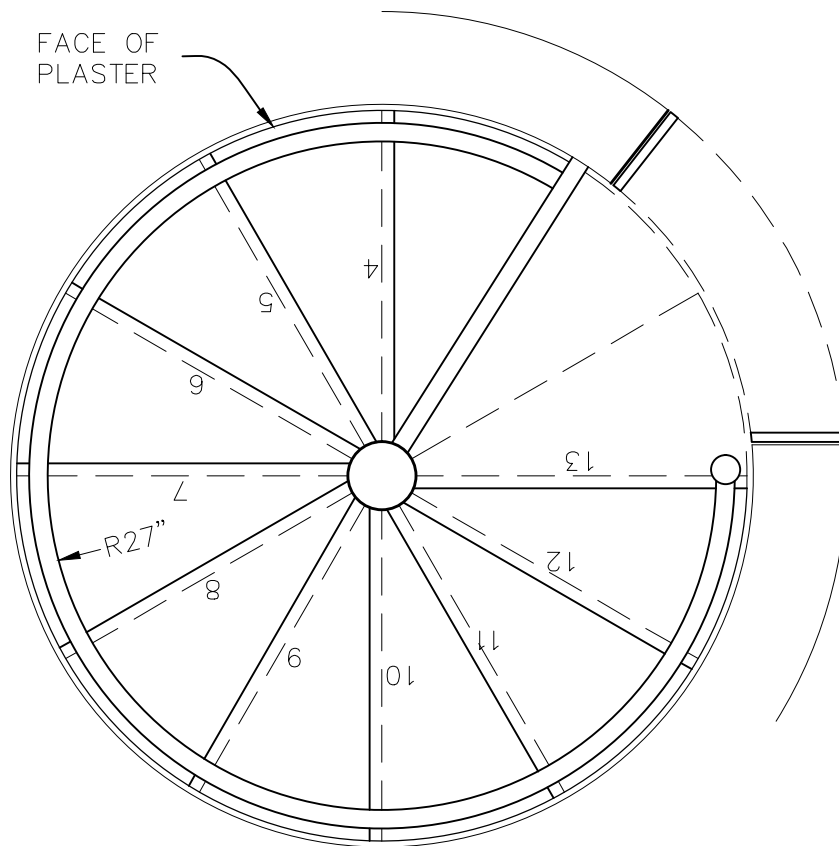

PLAN

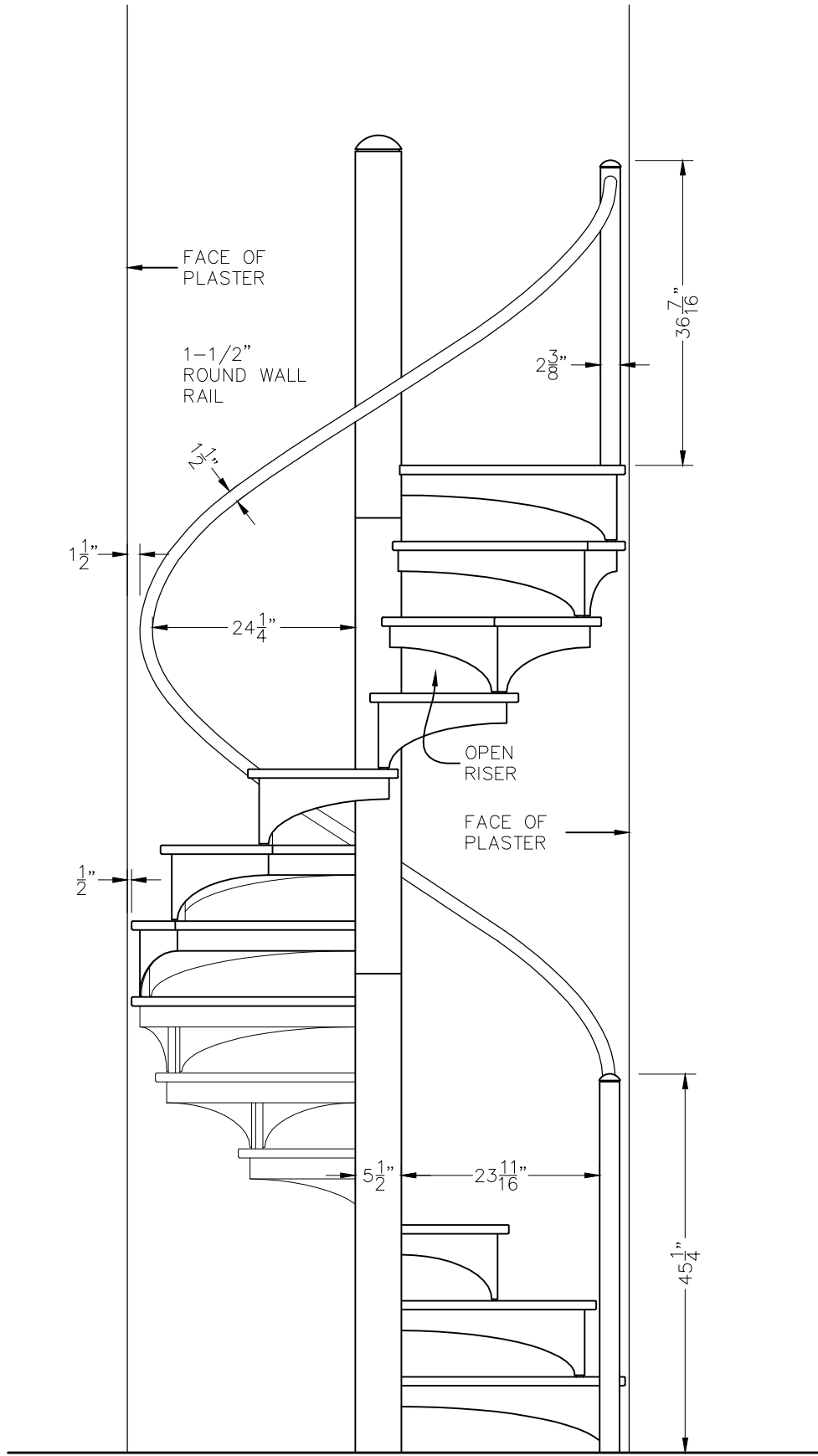

ELEVATION



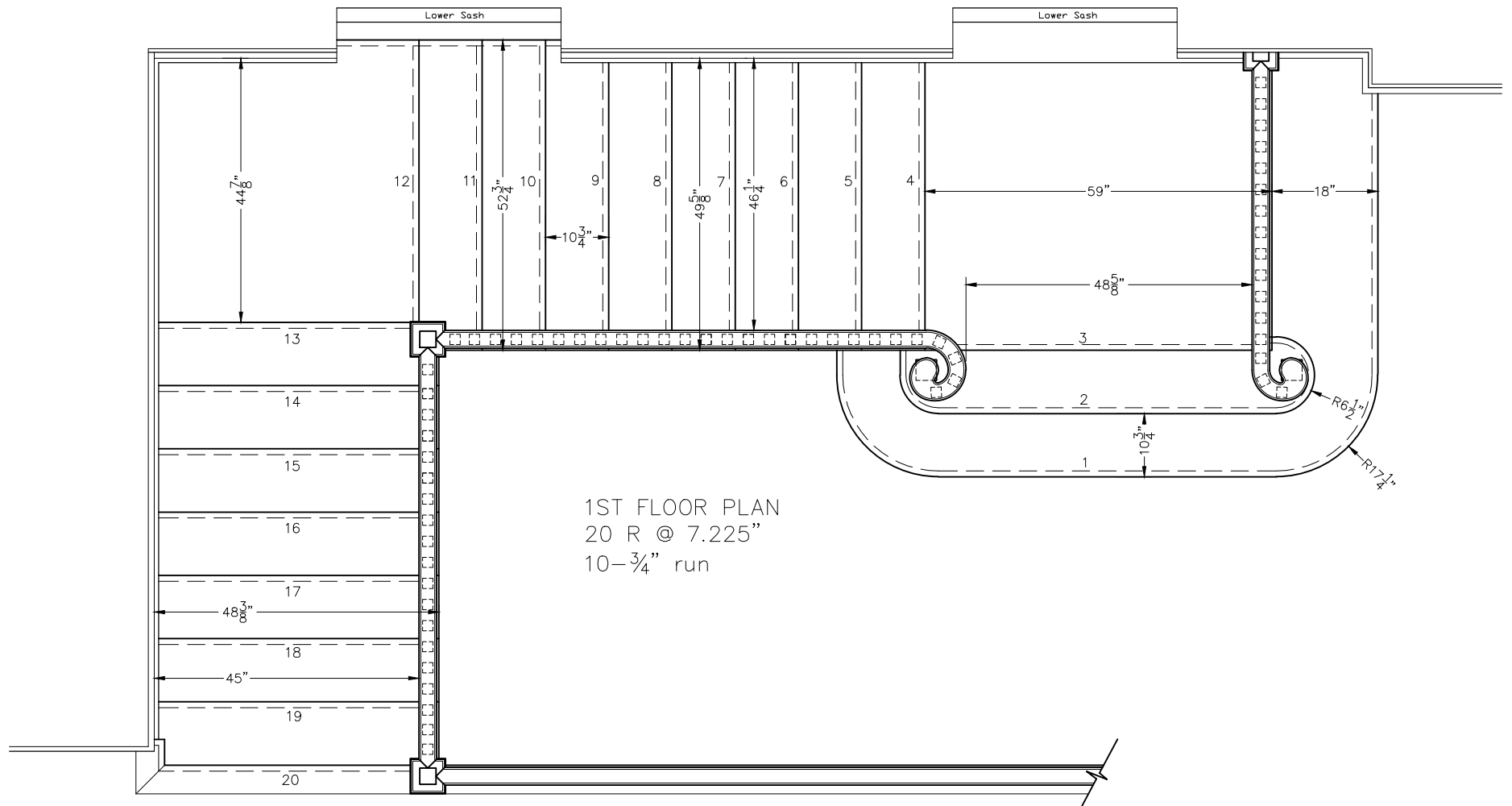

PLAN

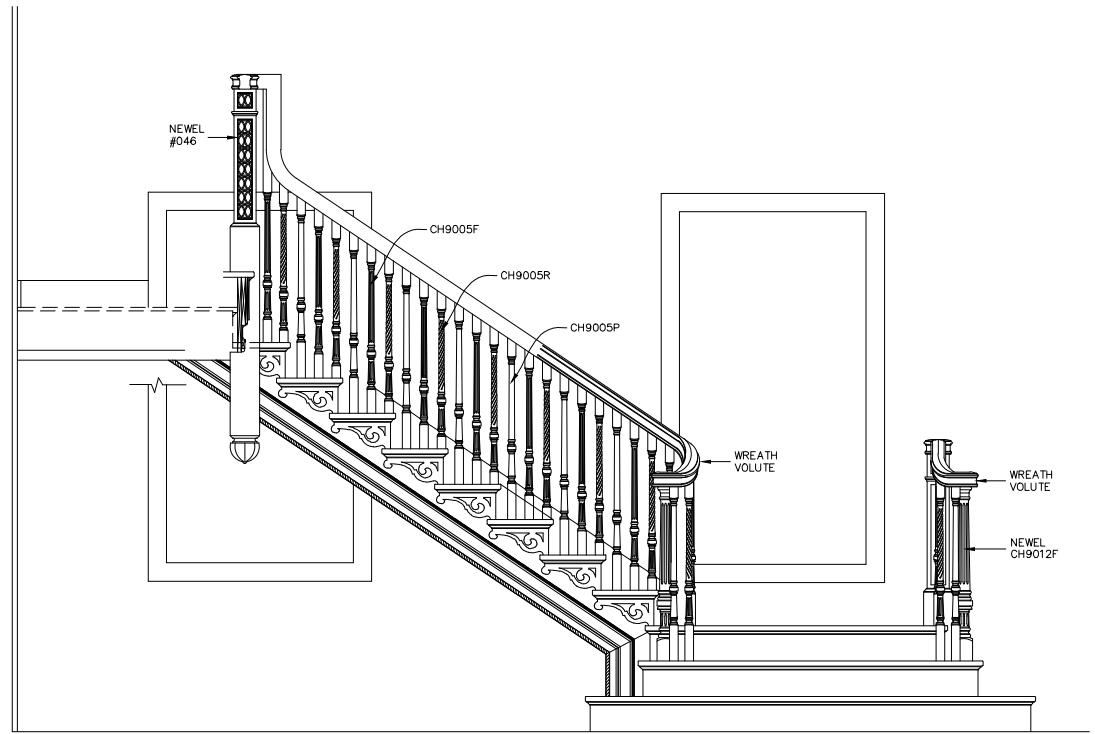
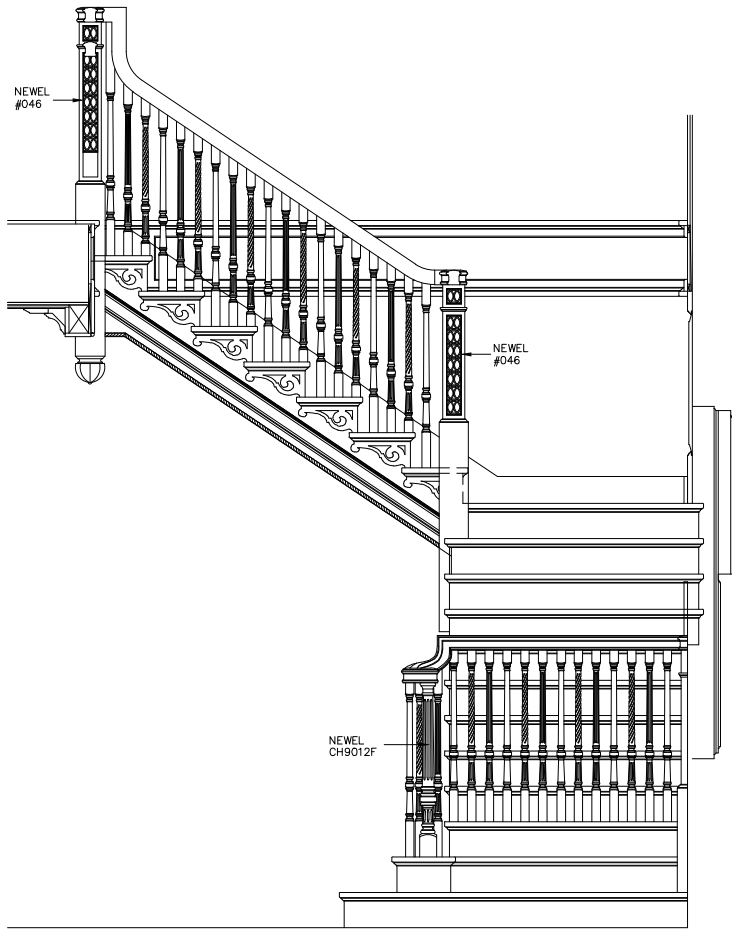

ELEVATIONS





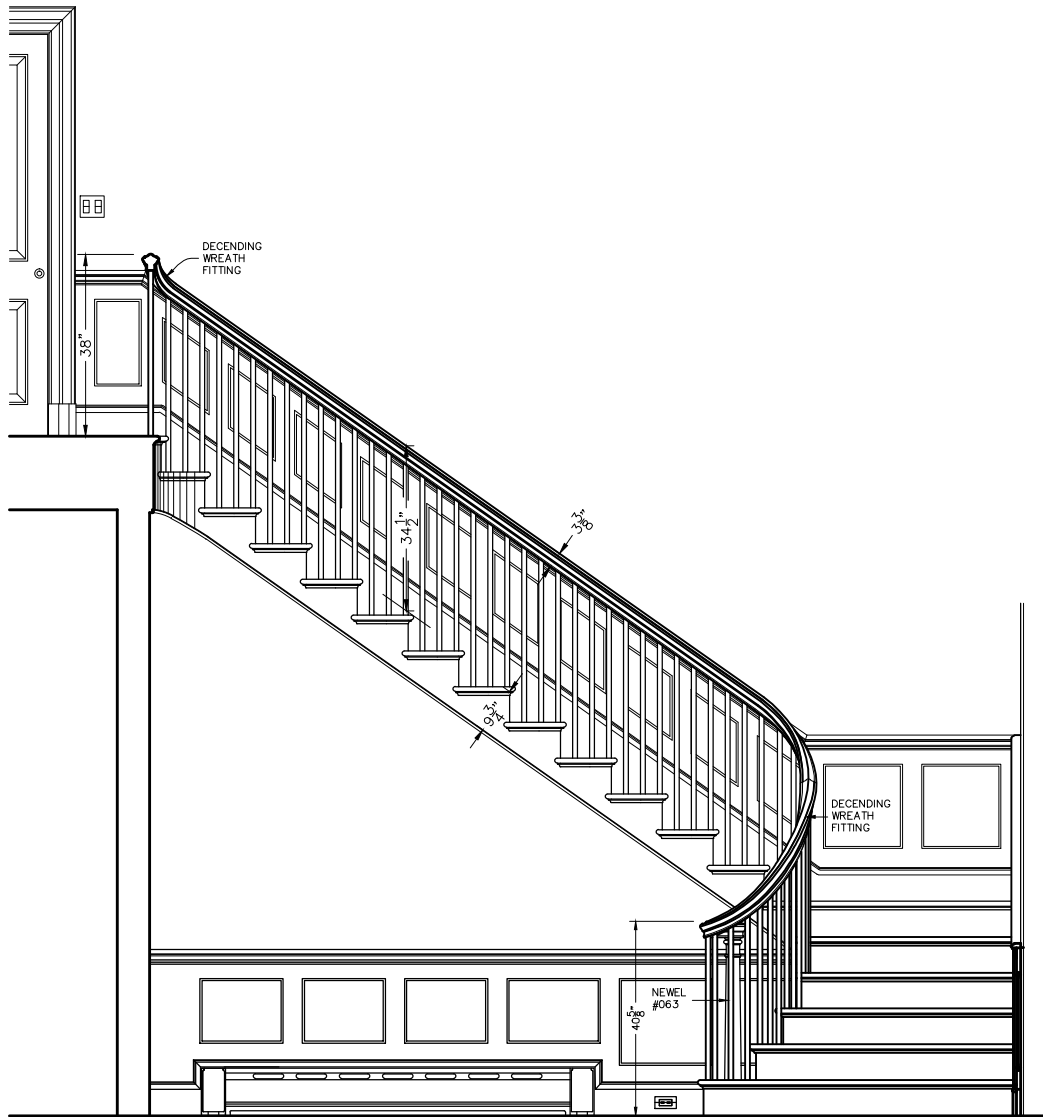

ELEVATION

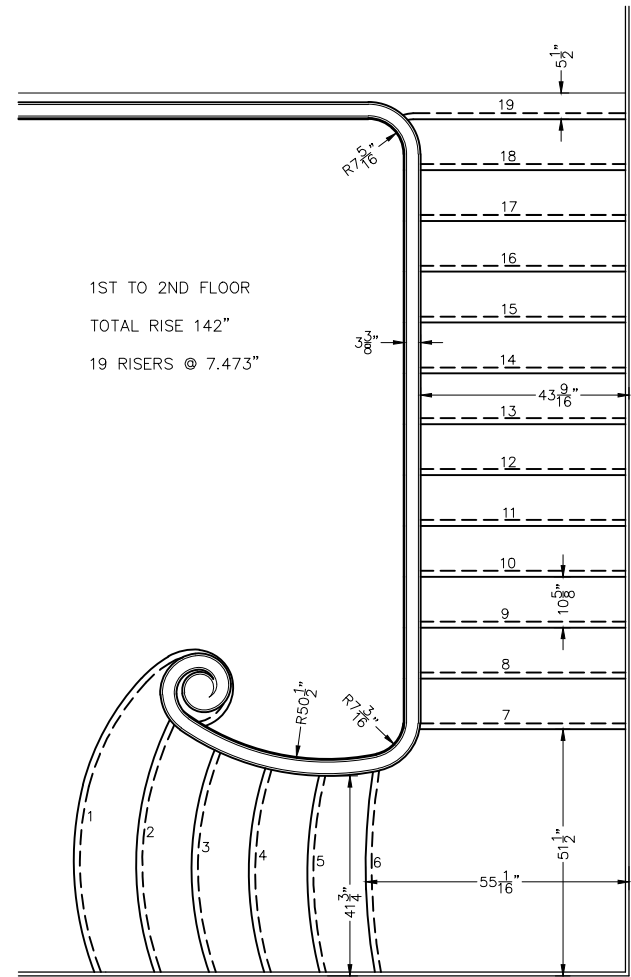

PLAN

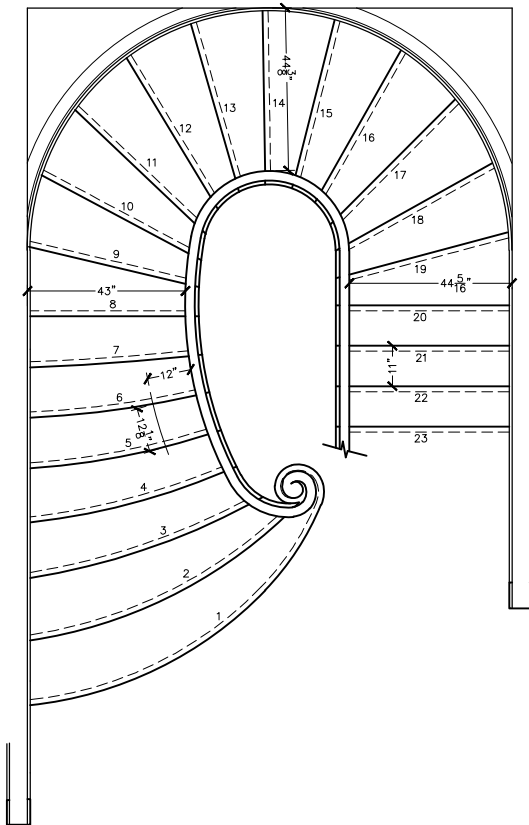

PLAN

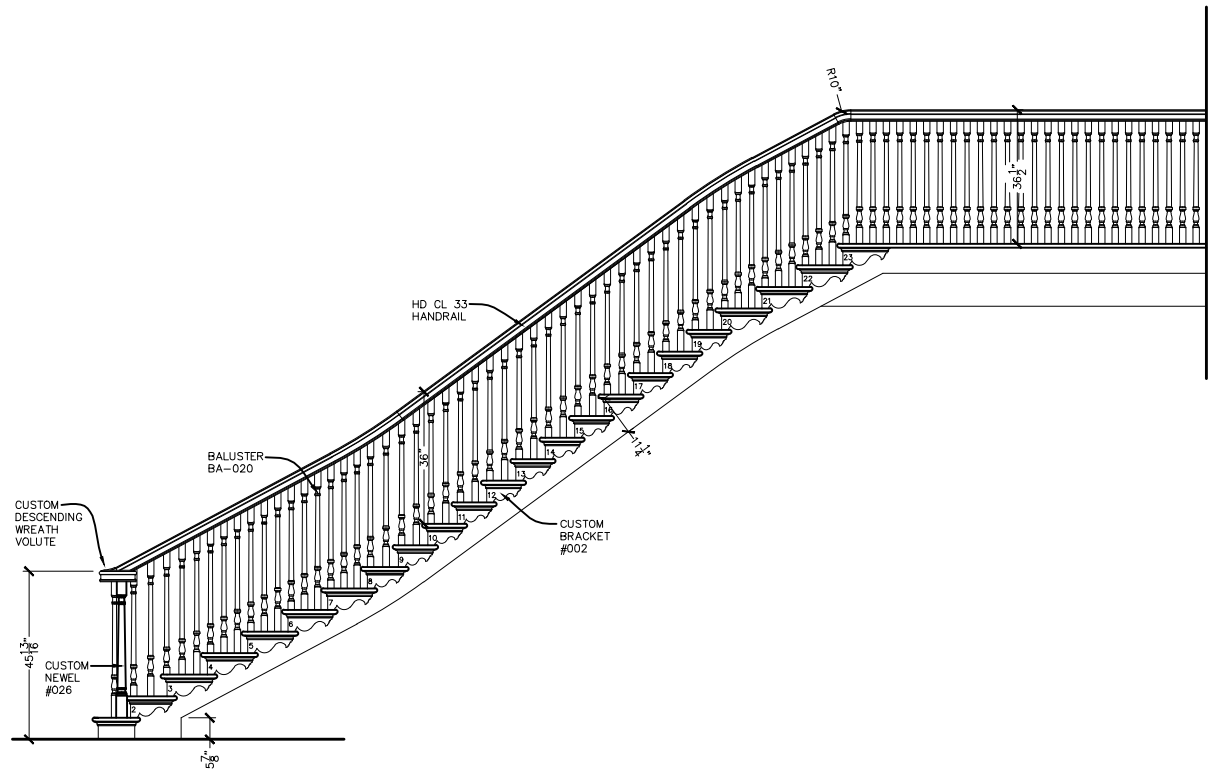

UNFOLDED ELEVATION